

Block 8

Wonderful Bow

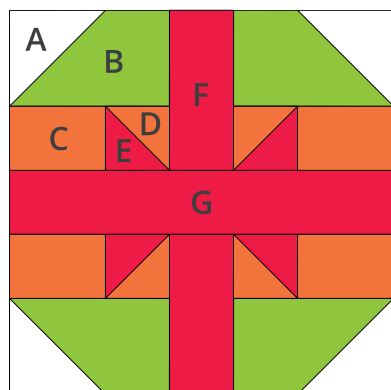

	4 x	2" x 2" (A)
	4 x	3" x 2" (B)
	4 x 2 x	2" x 1½" (C) 2" x 2" (D)
	2 x 2 x 1 x	2" x 2" (E) 3" x 1½" (F) 6½" x 1½" (G)

All measurements in Inch (")
Seam allowance: ¼ Inch
Size of the block: 6½" x 6½" (unfinished)

1. Draw a diagonal line on **square A** and put it right sides together on the left edge of **rectangle B**. Sew on the drawn line and cut away the excess fabric with ¼" seam allowance. **Repeat.**

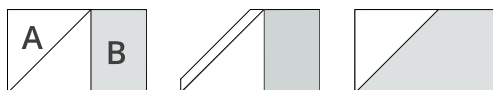

2. Draw a diagonal line on **square A** and put it right sides together on the right edge of **rectangle B**. Sew on the drawn line and cut away the excess fabric with ¼" seam allowance. **Repeat.**

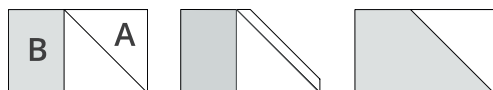

3. Draw a diagonal line on the wrong side of **square D** and put it right sides together with **square E**. Sew ¼" away on both sides of the drawn line. Cut on the diagonal line for 2 Half Square Triangles, press and trim to 1½". **Repeat.**

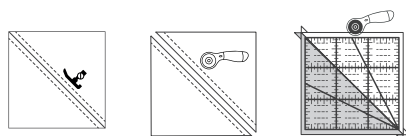

4. Sew one **rectangle C** to one Half Square Triangle. **Repeat 3 x.** Make sure the alignment is correct.



5. Put the units together according the scheme. **Repeat 3 x.** Be aware of the alignment of the 4 units.

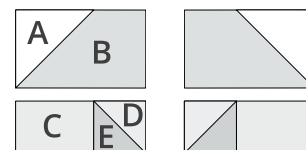

6. Put the block together according the scheme.

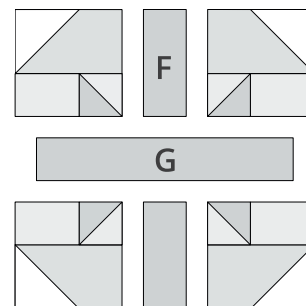

7. Stitch a »Wonderful Chain« block on the »Wonderful Bow« block according to the scheme.

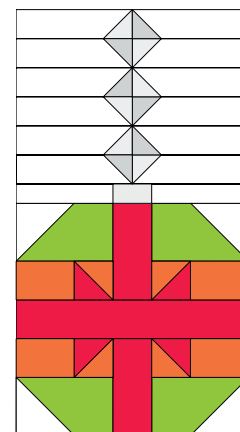

Have a wonderful time!

Show us your block at Facebook and Instagram with **#wonderfultimesal**